

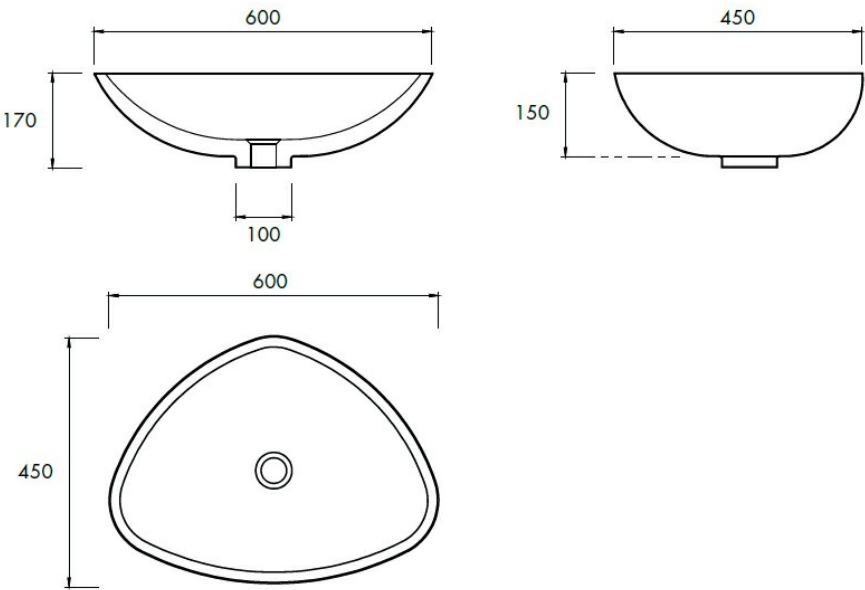





ECLIPSE VESSEL BASIN 600X450X170MM - DIAMOND WHITE

AP-6249X2.DW  
\$2549



|  |                                |  |
|--|--------------------------------|--|
|  | apaiserMARBLE®                 | apaiserMARBLE is a luxurious high performing marble, enriched with the purity of Australian minerals and is made from up to 90% reclaimed marble.  |
|  | Hand Crafted                   | Every piece of apaiser bathware is created by a team of highly experienced master craftsmen, who have perfected their trade over many years.   |
|  | Exceptional Thermal Properties | While retaining the sensual touch and luxurious feel of marble, apaiserMARBLE material delivers optimum strength, performance and is warm to touch with excellent heat retention.                              |
|  | Safe and Natural               | apaiser bathware pieces contain minimal man-made ingredients, are non-toxic with no added silica and free from aluminum trihydrate (ATH), so you can enjoy a guilt-free soak in a beautiful, sustainable bath. |
|  | Lighter than Natural Stone     | apaiserMARBLE is lighter than natural stone, while still delivering high performance and increased strength.   |
|  | Natural Slip Resistance        | The reclaimed materials that make up apaiserMARBLE give the final products a natural slip resistance while maintaining the luxurious feel of marble.   |
|  | Guarantee                      | 1 Year Guarantee - Outdoor Use   |
|  | Guarantee                      | 5 Year Guarantee   |
|  | Outdoor Use                    | Can be installed inside or outdoors.   |



|  |                                |   |
|--|--------------------------------|---|
|  | Weight                         | 15kg approx.<br>(Empty)   |
|  | BPIR - Importer                | Robertson NZ Ltd.   |
|  | BPIR - Place of Manufacture    | Thailand  |
|  | BPIR - Relevance Documentation | <p>For detailed information on Relevant Building Codes & Statement of Contribution please visit <a href="https://www.robertson.co.nz/downloads" target="_blank">ROBERTSON.CO.NZ/DOWNLOADS</a> and browse the relevant section</p> |
|  | BPIR - Scope of use            | Vessel basins are widely used in residential and commercial bathrooms to create a stylish, modern focal point, often chosen for their aesthetic appeal and suitability in vanity or countertop installations.                     |
|  | BPIR - B2.3.1 Durability       | This product complies with Building Code Regulation B2.3.1 Durability   |

The Apaiser Eclipse Vessel Basin (600 x 450 x 170mm) is a stunning item that is inspired by the natural elegance of cockle shells on the shore, and it will be an eye-catching feature in any luxury bathroom. This basin was originally created for a luxury, five-star resort and was designed by the apaiser Studio, and it has sophistication and artistic charm. The three-sided style perfectly mimics the natural curve and flow of the ocean, creating a warm central focal point in your bathroom.

With painstaking detail, the Eclipse Basin is carefully crafted using apaiserMARBLE®, an eco-friendly material containing Australian minerals and made of as much as 90% recycled marble. Lighter than natural stone yet maintaining higher strength and durability, the eco-material boasts not just rich looks and texture but also superior thermal properties, with the surface being warm to the touch for a decadent experience.

Aside from the beauty, Eclipse basin is safe and natural since it is produced without added silica or toxic products, making it a guilt-free choice for use in your household. The substance also has intrinsic slip resistance for added safety, while the luxury appeal of the basin is kept intact.

Perfect for indoor or outdoor mounting, the Eclipse Vessel Basin is backed by a 5-year warranty for its long term and hassle-free functionality. Weighing approximately 15kg, it's a stylish and heavy-duty option for any bathroom that combines innovative design with masterful craftsmanship to provide an enhancing touch to your ambience.